

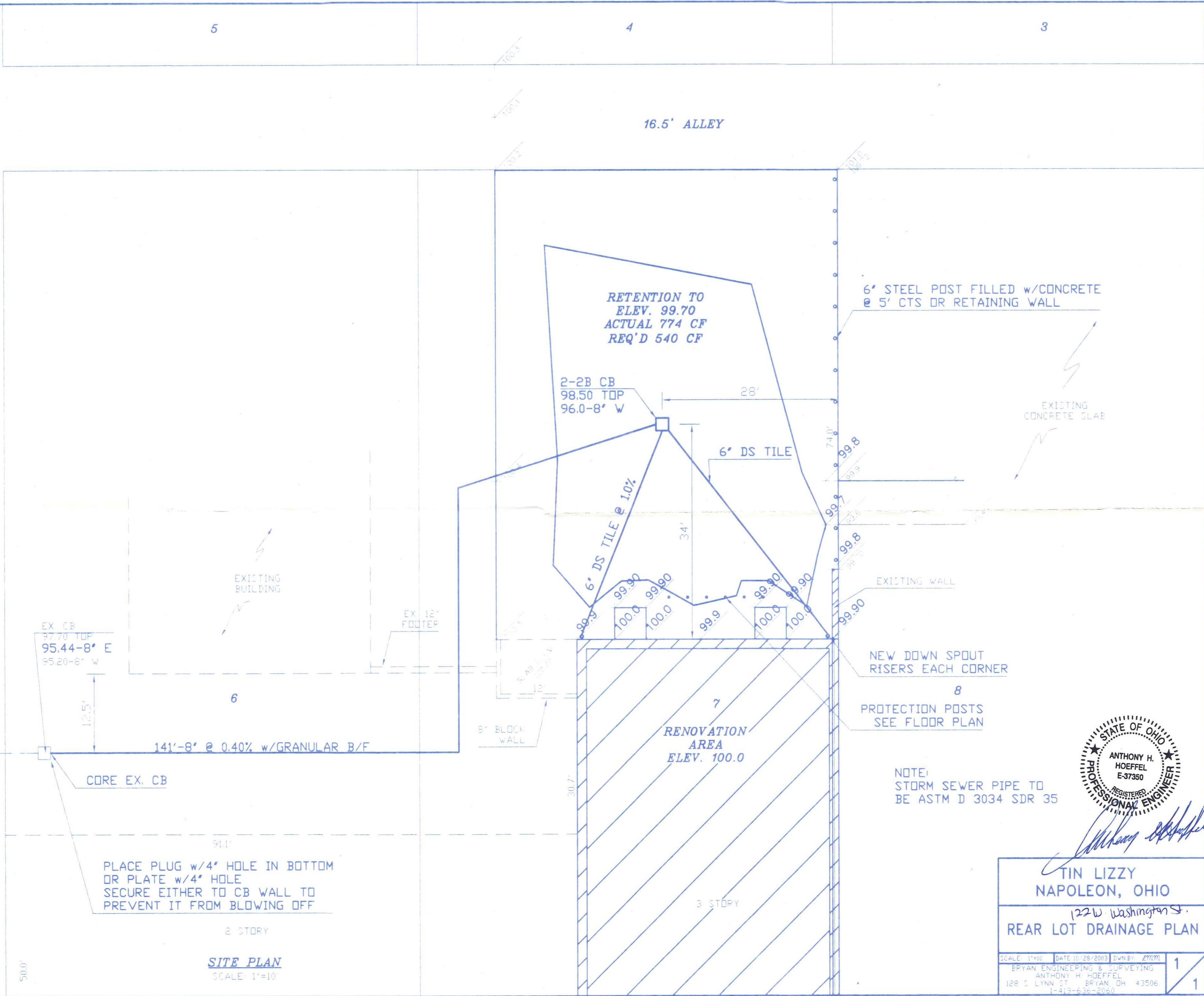

SCOTT STREET

16.5' ALLEY



EX. CB
97.70 TOP
95.44-8' E
95.20-8' W

2-2B CB
98.50 TOP
96.0-8' W

6" STEEL POST FILLED w/CONCRETE
@ 5' CTS OR RETAINING WALL

EXISTING
CONCRETE SLAB

EXISTING WALL

NEW DOWN SPOUT
RISERS EACH CORNER

PROTECTION POSTS
SEE FLOOR PLAN

NOTE:
STORM SEWER PIPE TO
BE ASTM D 3034 SDR 35



Tin Lizzy

TIN LIZZY
NAPOLEON, OHIO
122 W. Washington St.
REAR LOT DRAINAGE PLAN

PLACE PLUG w/4" HOLE IN BOTTOM
OR PLATE w/4" HOLE
SECURE EITHER TO CB WALL TO
PREVENT IT FROM BLOWING OFF

SITE PLAN
SCALE: 1"=10'

| | | | |
|--|------------------|-------------|---|
| SCALE: 1"=10' | DATE: 10/28/2003 | DWN BY: zmm | 1 |
| BRYAN ENGINEERING & SURVEYING ANTHONY H. HOEFFEL 128 S. LYNN ST. BRYAN, OH 43506 1-413-636-2060 | | | 1 |